

# LOGAN PARK NEIGHBORHOOD ASSOCIATION

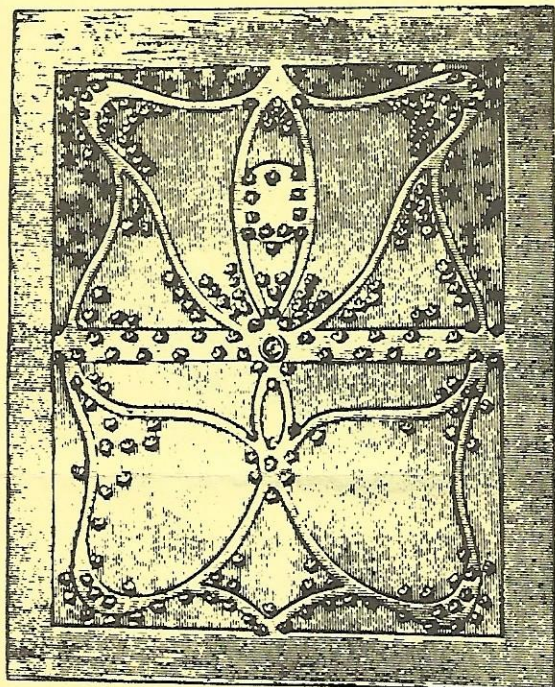

## To Enhance and Preserve Our Community

### LPNA BOARD OF DIRECTORS

1330 Van Buren St. NE • 781-0700

Jim Le Claire	<i>Chairperson</i>
Christine Burtness	<i>Vice Chair</i>
Russ Belk	<i>Treasurer</i>
Gail Schack	<i>Secretary</i>
Richard Betts	<i>Recording Secretary</i>

Denny Grodahl	Steve Jacobson
Mary Rose Ciatti	Paula Allen
Tom Harris	

**SPRING 1993**

### BOARD ELECTIONS

The Logan park Neighborhood Association will have its annual elections to the Board of Directors at its meeting on Wednesday, May 19 at 7:00 pm at the Community Center. There are ten members on the Board, with seven positions up for election this year, along with three alternates.

If you live or have a business in the Logan Park Neighborhood, bounded by Broadway, Central, 19th Avenue NE and Washington Street and have an interest in your community, we welcome your participation. Organized neighborhood input is shaping how the city makes its decisions, and LPNA is a forum for opinions and ideas on what happens in our area and our city. Friendships and a sense of community grow out of participation. See you there on the 19th!

### CLEAN UP

LPNA is sponsoring its annual Neighborhood Clean-up on Saturday, May 15. Last year was the best ever, so let's do it again. Starting at Washington and Broadway, a regular city garbage packer truck with LPNA volunteers will zig zag through the Logan Park neighborhood alleys to pick up burnables. They will start at 9:00 am and work their way towards Central Avenue, finishing around 2:00 pm. Please make sure to set your things out early and clearly at the alley. If you have a lot to load, try to keep an eye out for the truck and help the volunteers. Put items at your regular garbage collection site if you don't have an alley.

Appliances and metal items should be saved for recycling day and marked "*For Sanitation*" and they will be picked up the next day. Household hazardous wastes must go to the Hennepin County Transfer Station in Brooklyn Park. Save bagged clippings and leaves for regular garbage pick-up, as it goes for composting.

The popular dumpsters were cancelled city-wide this year. Instead, the South Transfer Station will be open from 9:00 - 3:30 on the 15th for tires, construction materials and large brush from our residents. It's located at 2850 20th Avenue South - enter on east 28th Street and go south on 20th Avenue. Call LPNA at 781-0700 if you have a truck and can share the load with a neighbor, and to get the necessary neighborhood authorization letter issued to the organization from CNAP.

Christine - 788-7863



## HOME TOUR

May 1 and 2 were dreary, rainy days, but that didn't stop 550 people from touring Logan Park's featured house on the Minneapolis/St. Paul Home Tour. The big red duplex at 1507 Washington, shown with pride by Aaron, Brian and Diane Hoffmann, was one of the most unique and interesting homes on the tour, according to many people going through. The owners all work in the arts and interior design, plus put heart, soul and countless hours of elbow grease rehabbing their home.

LPNA volunteers helped host the home on the tour and held a fundraiser snack stand. Thank you to: *Christine Burtness, Paula Allen, Gail Schack, Denny Grodahl, Brian Nelson, Ruth Griffith, Donna Norberg, Helen and Lyn Browne, Mary Rose Ciatti, Nancie Theissen, Pat Vogel, Tom Harris, Nancy Rekucki, Sandra Thomas and Kathy Oyen.*

We hope to have two homes on the tour next year - many Logan Park houses have the details that delight visitors. Lennie and Linda Sandall are showing their beautifully restored Adams Street home on the League of Women Voters Home Tour in May, and have done the Minneapolis/St. Paul Tour. The Hoffmaanns and the Sandells would be happy to share their experience with anyone interested in showing their home.

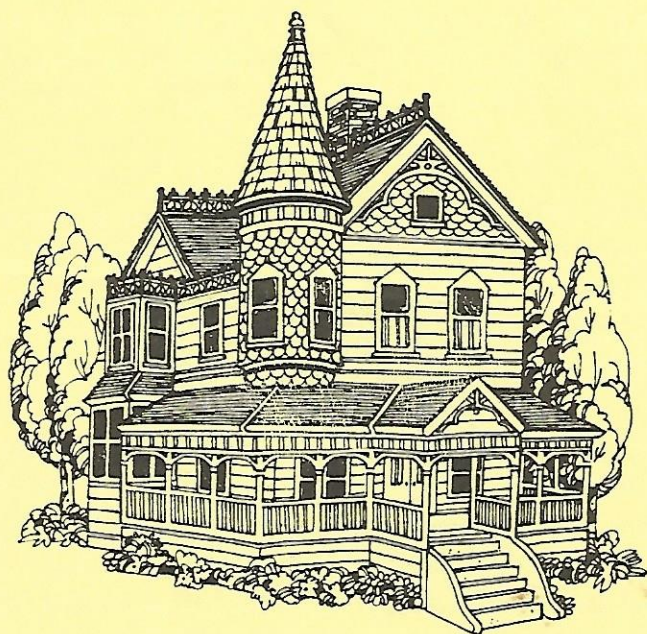

## HISTORIC GARDEN DISTRICT

The Logan Park neighborhood is a major part of the Historic Garden District, a popular volunteer project to beautify the area with colorful flower gardens. Many homes will reflect their European heritage. Watch Adams Street all the way to 17th for special theme gardens with new embellishments on the houses, too. Volunteers have built window boxes and are working on making compost and black dirt available, though more trucks are needed. Join your neighbors and add some color, especially to the front of your house - a hanging basket or whole new flower bed. We can expect citywide recognition for our efforts! Call Mark Kozlak at 639-6379 or Bob Shulstad at 379-2570 for more information on the Historic Garden District.

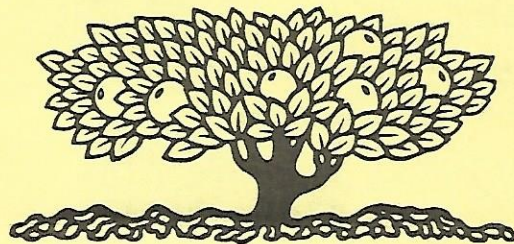

## MORE FLOWERS

The beautiful daffodils blooming at the Monroe and Broadway corner of Logan Park were planted in celebration of Citizenship Day last September. 2000 bulbs were planted at three sites: Logan Park, Webster School and St. Anthony Square at Monroe and 3rd Avenue. St. Anthony East Neighborhood co-sponsored the event with People for Parks, CUE, and Webster School, with over 200 kids helping to plant the flowers. We will be treated to these cheerful blossoms every spring now, and special thanks go to Mary Jane Partyka of St. Anthony East.

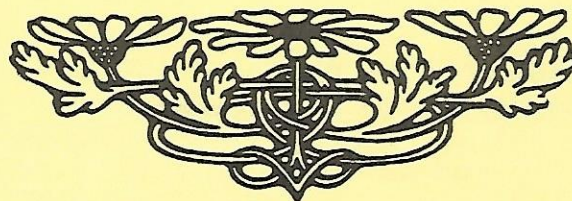



## MORE TREES

New trees are being planted on the inside boulevards. This is another phase of LPNA's reforestation program. These trees and the new ones planted last year are vulnerable and need to be cared for. If conditions get dry, they must be watered. It is the responsibility of the home owners and residents to water trees on or in front of their property - to "Adopt a Tree". If we don't nurture the trees we have, city money is tight and we're not likely to get many replacements.



## CURFEW

Summer curfew hours are as follows:

*Ages 14 and under:*

Sunday - Thursday: home by 10:00 pm

Friday & Saturday: home by 11:00 pm

*Ages 15 - 17*

Home by midnight.



## GATEWAY CELEBRATION

Celebrate the ethnic diversity of Northeast as the Gateway Arts Project is installed. Colorful metal sculptures representing design motifs of different countries will be installed at the Broadway and Central intersection, designated a gateway to Northeast. There will be an opening ceremony on Sunday, May 23rd at 2:00 pm, with refreshments, entertainment, and a chance to meet the artist, Susan Fiene.

## GARAGE SALE FUNDRAISER

Clean out the attic - check the basement - get rid of some of that old stuff - but remember, your junk may be someone else's treasure. LPNA is having a sale of donated items to help fund the projects coming up this year. We will be part of Logan Park Community Center's annual Garage Sale in the Park on Saturday, June 5th. LPNA is looking for good, used items - no clothing, please. Call us at 781-0700 if you have things to donate and we'll arrange the drop-off time, or come and pick up items from the handicapped or elderly.

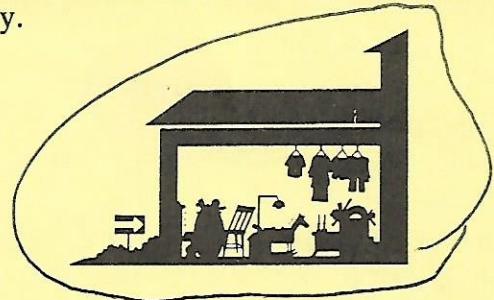

*Note:* The petition for installing turn-of-the-century style street lights is initiated by interested residents, and is not an LPNA endorsed project.

*Note:* Remember that leaving your clippings in the grass and mowing more often makes for a healthier yard. That and composting most of your yard waste saves you \$\$\$ in waste management tax money. Call one number now for all garbage and recycling questions: 673-2917.

*Note:* LPNA sponsored an information booth on living in Logan Park Neighborhood at the Home Buyer's Open House, held on May 8 at the Hale School, 54th Street and 12th Avenue South. We promote home ownership whenever we can.



## 18th AND CENTRAL

MCDA still is negotiating for a grocery store at the 18th and Central site. The pollution clean-up finances have been worked out, and there are still interested parties for a store there. LPNA will keep the neighborhood informed of any new progress.

## LANDLORDS - TENENTS

LPNA plans to focus on housing issues this coming year and to clean up problem houses by using block clubs, CCP/SAFE, inspections and the Housing Court System. We plan to work out solutions with tenants of negligent landlords, and landlords overwhelmed by bad renters and maintenance problems, as well as residents around these homes. There are funding programs available for different situations and LPNA will investigate any that may apply in our neighborhood.

## LOGO CHANGE?

The Board of the Logan Park Neighborhood Association is considering changing their logo. The current logo is located on the front of this newsletter at its heading. The logo under consideration is shown below. Please let us know your opinion on whether a change of this nature would be a good or a bad idea. Call us at 781-0700.

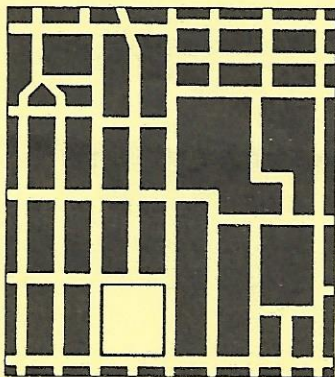

**LOGAN PARK**  
neighborhood  
association

## THEY'RE BACK

Logan Park is one of the twelve Northeast and Southeast neighborhoods to have bike, beat and canine patrols this summer. The friendly, personal visibility is part of what makes this program such a success. A police officer on a bike can also have a quiet, low-profile approach to catch a crime in action. This is part of community-oriented policing, as each neighborhood hires its own officers and sets the patrol times and routes. Our City Council awarded 2nd precinct the extra funding for this program, which already has had several years of success. The Northeast Reps will act as administrator of the finances, but organized block clubs will make the decisions. The special patrols will work with the regular squad patrols, so please use 911 to report crimes in action, suspicious activity, curfew violations, and to report break-ins, theft, vandalism & graffiti, and use the block clubs to work with your neighbors on problems.

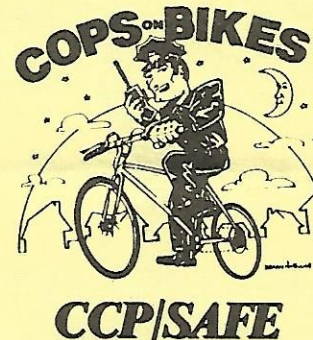

Block leader training, Wednesday, June 2, and Wednesday, June 9 from 7:00 - 9:00 pm at the CCP/SAFE office (at 217 South 3rd Street). Call 673-3065. Block clubs will work with the Bike Cops and also facilitate getting to know our officers on regular patrol who will be working permanent shifts this summer.

### LOGAN PARK NEIGHBORHOOD ASSOCIATION MISSION STATEMENT

*To empower the residents to preserve, protect and improve the quality of life, while building a strong sense of community within our neighborhood.*